

CITYMATE™

CIBELES 80L



SULO®

Architectural design that makes identity visible

CIBELES 80L



The perfect shape to add quality to special places

- Designed by the architectural firm Ricardo Bofill & Marta de Vilallonga
- The elegant and recognisable shape fits harmoniously into the urban landscape
- Made of robust cast aluminum
- Stainless Steel ashtray, Standard
- Inner basket made of rotomolded polyethylene (PELLD)
- Fire resistant
- Fixing to the ground
- Lock to prevent tampering
- Customizable by means of a mold insert or metal sheet

Dimensions

Volume (L)	80
Height (mm) ~	1040
Width (mm) ~	470
Length (mm) ~	345
Weight (kg) ~	36,1



EMPTYING AND MAINTENANCE

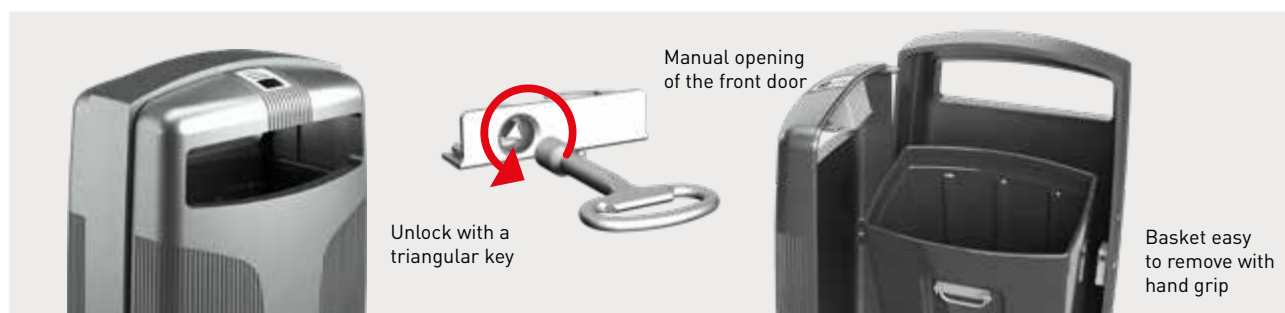

INSTALLATION



The installation of this model of bin is made by fixing it to the ground with four anchor bolts, being able to screw (with an optional plate) it to the ground.

OPTIONS



RFID Tag

COLOURS

Grey Madrid GD
RAL 7043



UMBRA GREY KI
RAL 7022



MADRID BLUE MB
RAL 5013



ENGLISH GREEN VF
PANTONE 5535 C



sulo.com

DATA-CITYMATE-CIBELES-80L-EN-1-0-061221

SULO®